

**CONSTRUCTION NOTES**

- THIS PLAN HAS BEEN REVIEWED BY THE CITY AND/OR ITS AUTHORIZED REPRESENTATIVE, BUT SUCH CHECKING AND/OR APPROVAL DOES NOT RELIEVE THE CONTRACTOR FROM HIS RESPONSIBILITY TO CORRECT ERRORS, OMISSIONS OR MAKE CHANGES REQUIRED BY CONDITIONS DISCOVERED IN THE FIELD DURING THE COURSE OF CONSTRUCTION. CIVIL ENGINEER & THE CITY MUST BE INFORMED IN WRITING OF ANY CHANGES MADE DURING CONSTRUCTION PRIOR TO EXECUTION OF THE SAID CHANGE.
- ALL REVISIONS TO THIS PLAN MUST BE REVIEWED BY THE GOVERNING AGENCY(S) PRIOR TO CONSTRUCTION AND SHALL BE ACCURATELY SHOWN ON REVISED PLANS STAMPED AND SIGNED BY THE APPROPRIATE GOVERNING AGENCY(S) PRIOR TO THE INSTALLATION OF THE IMPROVEMENTS.
- THE CONTRACTOR SHALL NOT PERFORM ANY EXCAVATION OPERATIONS UNTIL ALL UTILITY COMPANIES, STATE, COUNTY, AND CITY AGENCIES HAVE BEEN NOTIFIED AND GIVEN THE OPPORTUNITY TO MARK THEIR FACILITIES IN THE FIELD.
- THE CONTRACTOR SHALL DETERMINE THE EXACT LOCATION OF ALL EXISTING UTILITIES BEFORE COMMENCING WORK, AND AGREES TO ASSUME ALL LIABILITY FOR ANY AND ALL DAMAGES WHICH MAY OCCUR DUE TO THE CONTRACTOR'S FAILURE TO PHYSICALLY LOCATE AND PRESERVE ANY AND ALL UNDERGROUND UTILITIES.
- ALL WORK SHALL BE PER OSHA AND APPLICABLE FEDERAL, STATE AND LOCAL CODE REQUIREMENTS.
- THE CONTRACTOR SHALL SECURE ALL REQUIRED ENCROACHMENT AND/OR OTHER PERMITS FROM ALL GOVERNING AGENCIES BEFORE THE COMMENCEMENT OF WORK.
- CONTRACTOR AGREES THAT HE/SHE SHALL ASSUME SOLE AND COMPLETE RESPONSIBILITY FOR JOB SITE CONDITIONS DURING THE COURSE OF CONSTRUCTION OF THIS PROJECT, INCLUDING SAFETY OF ALL PERSONS AND PROPERTY. THAT THIS REQUIREMENT SHALL APPLY CONTINUOUSLY AND NOT BE LIMITED TO NORMAL WORKING HOURS; AND THAT THE CONTRACTOR SHALL DEFEND, INDEMNIFY AND HOLD HARMLESS THE OWNER, ARCHITECT, CITY, AND ENGINEER FROM ANY AND ALL LIABILITY, REAL OR ALLEGED, IN CONNECTION WITH THE PERFORMANCE OF WORK ON THIS PROJECT, EXCEPTING FOR LIABILITY ARISING FROM THE SOLE NEGLIGENCE OF THE OWNER, ARCHITECT, OR ENGINEER. THE ENGINEER ASSUMES NO RESPONSIBILITY EXCEPT FOR THE ADEQUACY OF HIS DESIGN CONTAINED HEREIN.
- EXISTING A.C. PAVING AND/OR CONCRETE SHALL BE CUT TO A NEAT, STRAIGHT LINE (WHEN APPLICABLE). INITIAL CUT SHALL BE EQUAL TO THE WIDTH OF TRENCH. FINAL CUT SHALL BE 6" WIDER ON EACH SIDE PER CITY OF ATWATER STANDARD PLAN 1-1. ALL EXPOSED VERTICAL SURFACES SHALL BE TACK COATED BELOW FINISH GRADE LINE WITH ASPHALT EMULSION PRIOR TO PAVING.
- ALL SURVEY MONUMENTS WITHIN THE AREA OF CONSTRUCTION SHALL BE PRESERVED OR, IF DAMAGED, RESET BY A LICENSED LAND SURVEYOR AT THE EXPENSE OF THE CONTRACTOR.
- ALL GRADING SHALL CONFORM TO CITY GRADING ORDINANCE AND SHALL BE IN ACCORDANCE WITH 2013 CBC APPENDIX J AND ANY APPLICABLE CALTRANS SPECIFICATIONS.
- NO GRADING SHALL BE ONTO ADJACENT PROPERTY WITHOUT WRITTEN PERMISSION OF PROPERTY OWNER.
- THE CONTRACTOR SHALL OBTAIN A GRADING PERMIT AND ABIDE BY ALL CONDITIONS THEREOF AND PAY PERMIT FEES.
- CONTRACTOR IS RESPONSIBLE FOR RESETTling EXISTING MONITORING WELLS, MANHOLES, CLEAN-OUTS, VALVE BOXES, UTILITY VAULTS, OR ANY OTHER STRUCTURES TO REMAIN, TO FINISH GRADE AS NECESSARY AND THESE SHALL BE INCLUDED IN THE CONTRACTORS RESPONSE TO THE REQUEST FOR BID.
- UNLESS OTHERWISE NOTED, ALL CURBS SHALL HAVE A 6" CURB FACE. DRILL AND EPOXY REBAR WHEN ABUTTING EXISTING CURBS.
- ASPHALTIC CONCRETE PAVEMENT SHALL BE PLACED IN TWO OR MORE LIFTS PER CITY STANDARD SPECIFICATIONS.
- THE CONTRACTOR SHALL REMOVE ALL ROOTS WITHIN 24" OF PROPOSED CONCRETE CURB, GUTTER, SIDEWALK AND DRIVEWAYS.
- CONCRETE CONFORM FOR PRIVATE SIDEWALKS AND DRIVEWAYS SHALL NOT EXCEED A MAXIMUM SLOPE OF 12%. CONTRACTOR MAY HAVE TO REMOVE ADDITIONAL CONCRETE TO ACCOMPLISH THE MAXIMUM 12% CONFORM.
- INSTALL ROOT BARRIERS PER DETAIL J SHEET 15 AT ALL LOCATIONS WHERE SIDEWALK AND/OR CURB AND GUTTER WILL BE CONSTRUCTED ADJACENT TO EXISTING TREES.

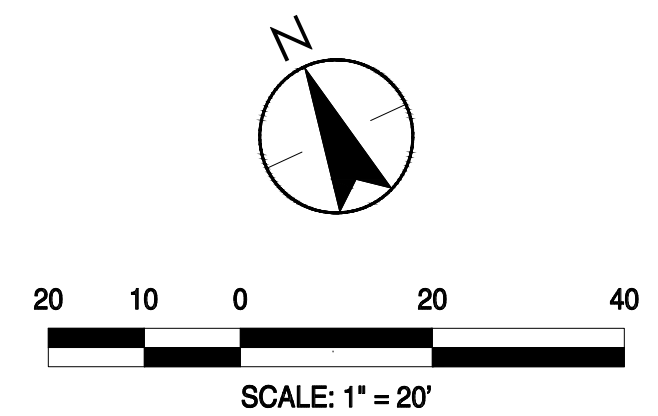

**KEYNOTES**

- CONSTRUCT SIDEWALK PER CITY OF ATWATER STANDARD DETAIL SCG-2
- CONSTRUCT 6" VERTICAL CURB AND GUTTER PER CALTRANS STANDARD DETAIL A87A, SHEET 13. (MAX. GUTTER SLOPE OF 5% AT ALL CURB RAMPS)
- CONSTRUCT RESIDENTIAL DRIVEWAY APPROACH PER CITY OF ATWATER DETAIL DR-2, SHEET 13
- CONSTRUCT DRIVEWAY APPROACH PER CITY OF ATWATER DETAIL DR-1, SHEET 13
- CONSTRUCT NEW PAVEMENT SECTION, 2.5" HMA OVER 5.5" CLASS II AB ON NATIVE SOILS SCARIFIED AND RECOMPACTED TO 95% R.D. FOR MINIMUM 6" DEPTH. REPLACEMENT AREA SHALL BE MINIMUM 2' WIDE AND PARALLEL WITH NEW LIP OF GUTTER
- CONSTRUCT CONCRETE DRIVEWAY TRANSITION. DISTANCE VARIES WITH A PREFERRED MAXIMUM SLOPE NOT TO EXCEED 8% WITH AN ALLOWABLE MAXIMUM SLOPE OF 12%
- CONSTRUCT CONCRETE SIDEWALK (PRIVATE) CONFORM
- CONSTRUCT ACCESSIBLE CURB RAMP PER DETAILS, SHEET 14
- RESPECTIVE UTILITY COMPANY TO ADJUST EXISTING TELEPHONE STRUCTURE TO FINISH GRADE
- NOT USED THIS SHEET
- NOT USED THIS SHEET
- NOT USED THIS SHEET
- ADJUST EXISTING WATER METER BOX TO FINISH GRADE
- RELOCATE EXISTING WATER METER BOX
- MEET AND MATCH EXISTING IMPROVEMENTS
- CONSTRUCT PRIVATE DRAIN INLET AND THRU-CURB DRAIN PER DETAILS 6 AND 9, SHEET 14
- CONSTRUCT CALTRANS "GO" INLET PER CALTRANS STD PLAN D72E
- INSTALL 1.5" PVC SCH40 SLEEVE EXTENDING 6" PAST SIDEWALK, BOTH SIDES
- ADJUST EXISTING WATER VALVE TO FINISH GRADE
- RECONSTRUCT TO MATCH WITH TOP OF FIRST STEP OF STAIR CASE
- CONNECT TO EXISTING STORM DRAIN AND EXTEND TO NEW CATCH BASIN AS SHOWN. EXISTING PIPE IS ASSUMED TO BE 12" RCP. VERIFY SIZE AND MATERIAL PRIOR TO CONSTRUCTION
- INSTALL THRU-CURB DRAINS PER DETAIL 2, SHEET 14

**SHEET LEGEND**

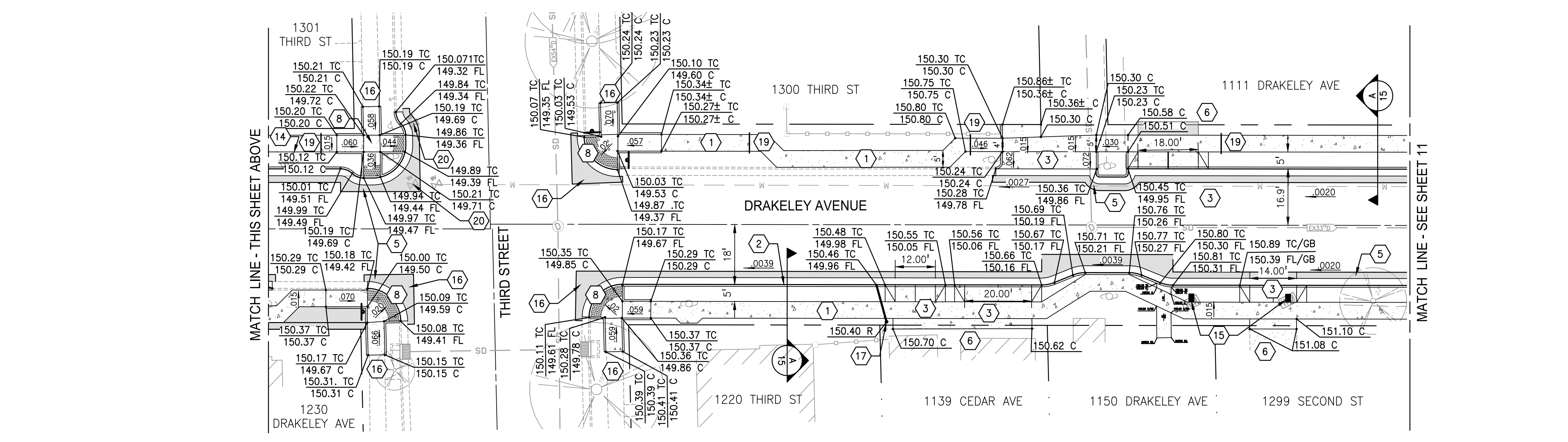
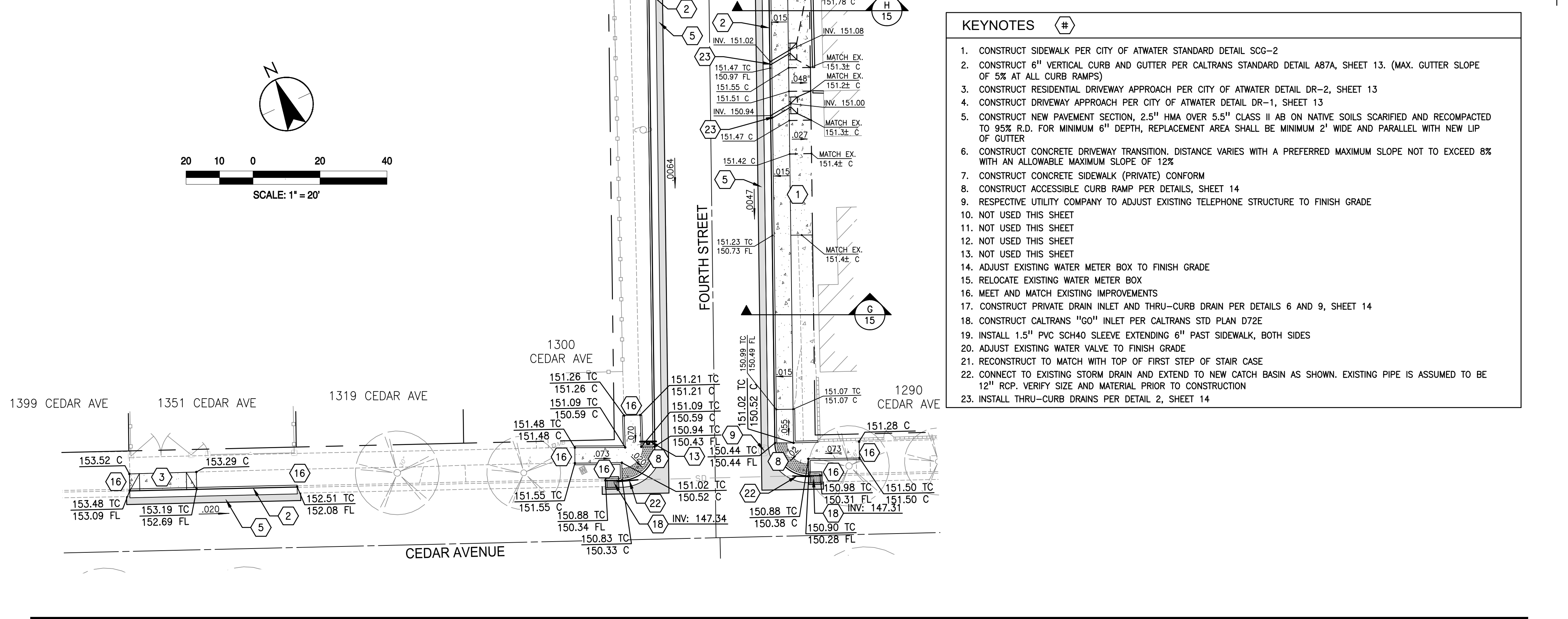
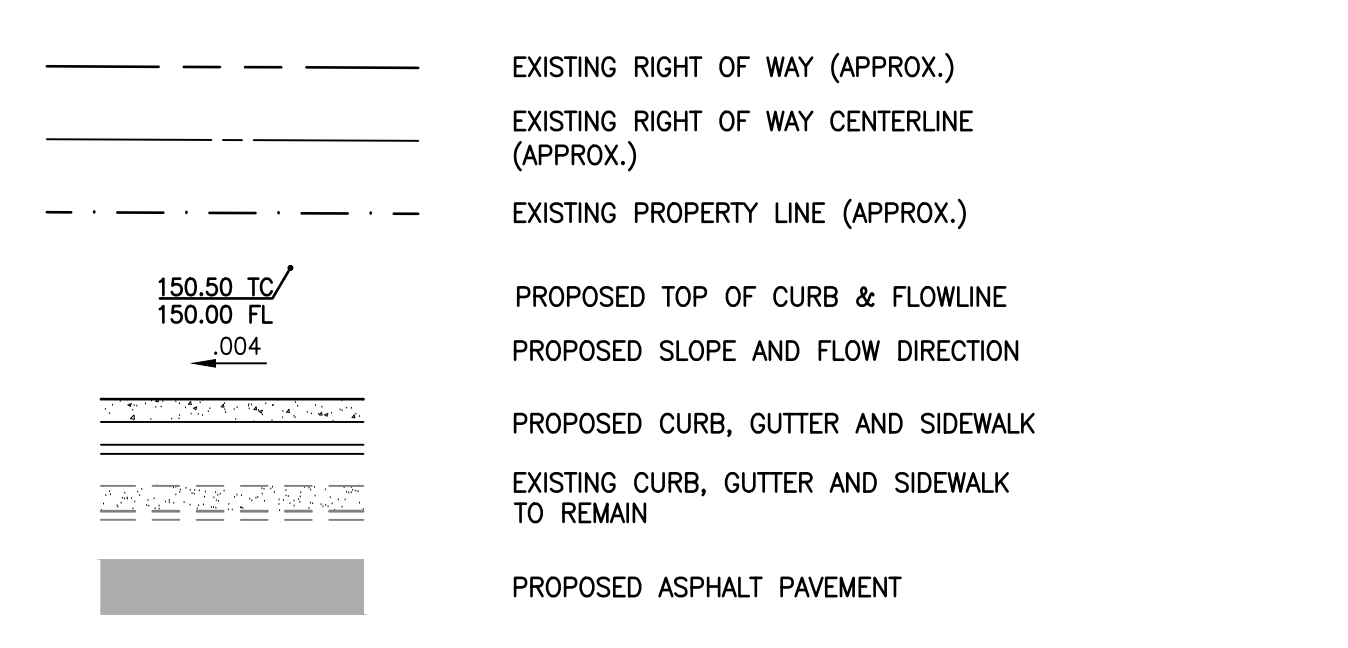

No.	DATE	DESCRIPTION	BY	APP'D.

Client/Project  
**CITY OF ATWATER**  
**DOWNTOWN PEDESTRIAN IMPROVEMENT PROJECT - PHASE II**  
 BID CALL NUMBER: 731-25  
 CITY PROJECT NUMBER: 20-8  
 FEDERAL PROJECT NUMBERS: CML-5254 (031) & CRP-5254 (031)  
 ATWATER, CALIFORNIA

**CONSTRUCTION PLAN**

Engineer's Seal  
  
 Signature Date: 01.15.2025

  
 Project Engineer: ROB CHRISTENSEN  
 Project Number: 1093-1200  
 File Name: 10\_CONST  
 AR RC AR 01.16.25  
 Dwn Chkd. Dgmn. MM.DD.YY  
 Sheet No.

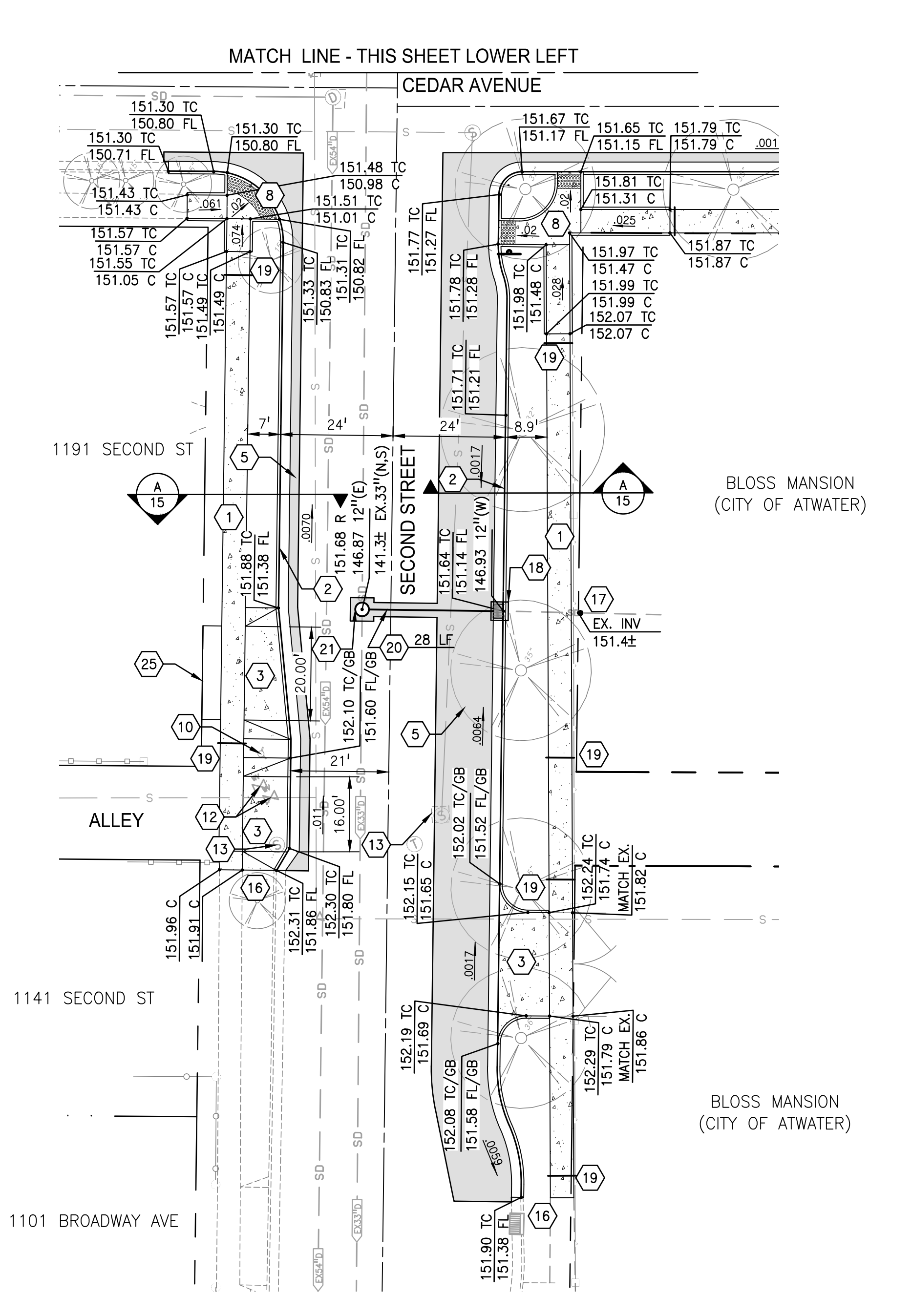
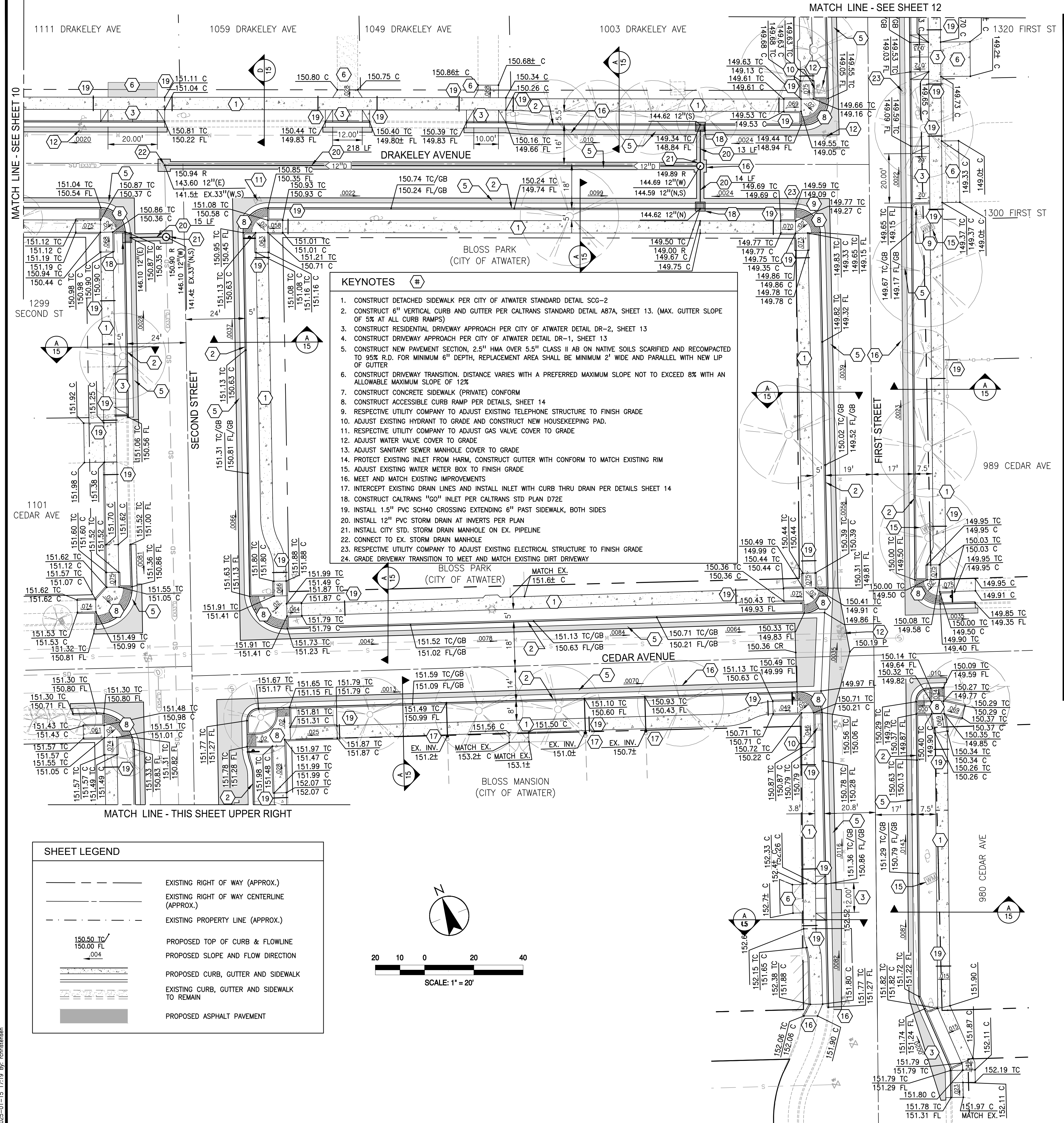

- KEYNOTES**
1. CONSTRUCT DETACHED SIDEWALK PER CITY OF ATWATER STANDARD DETAIL SCG-2
  2. CONSTRUCT 6" VERTICAL CURB AND GUTTER PER CALTRANS STANDARD DETAIL A87A, SHEET 13. (MAX. GUTTER SLOPE OF 5% AT ALL CURB RAMPS)
  3. CONSTRUCT RESIDENTIAL DRIVEWAY APPROACH PER CITY OF ATWATER DETAIL DR-2, SHEET 13
  4. CONSTRUCT DRIVEWAY APPROACH PER CITY OF ATWATER DETAIL DR-1, SHEET 13
  5. CONSTRUCT NEW PAVEMENT SECTION, 2.5" HMA OVER 5.5" CLASS II AB ON NATIVE SOILS SCARIFIED AND RECOMPACTED TO 95% R.D. FOR MINIMUM 6" DEPTH, REPLACEMENT AREA SHALL BE MINIMUM 2' WIDE AND PARALLEL WITH NEW LIP OF GUTTER
  6. CONSTRUCT DRIVEWAY TRANSITION. DISTANCE VARIES WITH A PREFERRED MAXIMUM SLOPE NOT TO EXCEED 8% WITH AN ALLOWABLE MAXIMUM SLOPE OF 12%
  7. CONSTRUCT CONCRETE SIDEWALK (PRIVATE) CONFORM
  8. CONSTRUCT ACCESSIBLE CURB RAMP PER DETAILS, SHEET 14
  9. RESPECTIVE UTILITY COMPANY TO ADJUST EXISTING TELEPHONE STRUCTURE TO FINISH GRADE
  10. ADJUST EXISTING HYDRANT TO GRADE AND CONSTRUCT NEW HOUSEKEEPING PAD.
  11. RESPECTIVE UTILITY COMPANY TO ADJUST GAS VALVE COVER TO GRADE
  12. ADJUST WATER VALVE COVER TO GRADE
  13. ADJUST SANITARY SEWER MANHOLE COVER TO GRADE
  14. PROTECT EXISTING INLET FROM HARM, CONSTRUCT GUTTER WITH CONFORM TO MATCH EXISTING RIM
  15. ADJUST EXISTING WATER METER BOX TO FINISH GRADE
  16. MEET AND MATCH EXISTING IMPROVEMENTS
  17. INTERCEPT EXISTING DRAIN LINES AND INSTALL INLET WITH CURB THRU DRAIN PER DETAILS SHEET 14
  18. CONSTRUCT CALTRANS "GO" INLET PER CALTRANS STD PLAN D72E
  19. INSTALL 1.5" PVC SCH40 CROSSING EXTENDING 6" PAST SIDEWALK, BOTH SIDES
  20. INSTALL 12" PVC STORM DRAIN AT INVERTS PER PLAN
  21. INSTALL CITY STD. STORM DRAIN MANHOLE ON EX. PIPELINE
  22. CONNECT TO EX. STORM DRAIN MANHOLE
  23. RESPECTIVE UTILITY COMPANY TO ADJUST EXISTING ELECTRICAL STRUCTURE TO FINISH GRADE
  24. GRADE DRIVEWAY TRANSITION TO MEET AND MATCH EXISTING DIRT DRIVEWAY

**SHEET LEGEND**

	EXISTING RIGHT OF WAY (APPROX.)
	EXISTING RIGHT OF WAY CENTERLINE (APPROX.)
	EXISTING PROPERTY LINE (APPROX.)
	PROPOSED TOP OF CURB & FLOWLINE
	PROPOSED SLOPE AND FLOW DIRECTION
	PROPOSED CURB, GUTTER AND SIDEWALK
	EXISTING CURB, GUTTER AND SIDEWALK TO REMAIN
	PROPOSED ASPHALT PAVEMENT

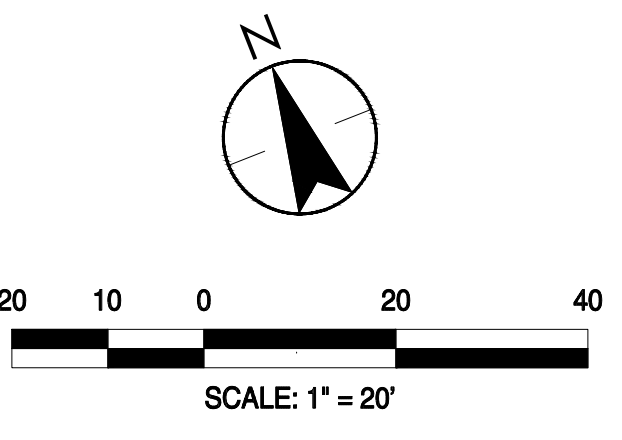

**CONSTRUCTION NOTES**

1. THIS PLAN HAS BEEN REVIEWED BY THE CITY AND/OR ITS AUTHORIZED REPRESENTATIVE, BUT SUCH CHECKING AND/OR APPROVAL DOES NOT RELIEVE THE CONTRACTOR FROM HIS RESPONSIBILITY TO CORRECT ERRORS, OMISSIONS OR MAKE CHANGES REQUIRED BY CONDITIONS DISCOVERED IN THE FIELD DURING THE COURSE OF CONSTRUCTION. THE CONTRACTOR SHALL BE INFORMED IN WRITING OF ANY CHANGES MADE DURING CONSTRUCTION PRIOR TO EXECUTION OF THE SAID CHANGE.
2. ALL REVISIONS TO THIS PLAN MUST BE REVIEWED BY THE GOVERNING AGENCY(S) PRIOR TO CONSTRUCTION AND SHALL BE ACCURATELY SHOWN ON REVISED PLANS STAMPED AND SIGNED BY THE APPROPRIATE GOVERNING AGENCY(S) PRIOR TO THE INSTALLATION OF THE IMPROVEMENTS.
3. THE CONTRACTOR SHALL NOT PERFORM ANY EXCAVATION OPERATIONS UNTIL ALL UTILITY COMPANIES, STATE, COUNTY, AND CITY AGENCIES HAVE BEEN NOTIFIED AND GIVEN THE OPPORTUNITY TO MARK THEIR FACILITIES IN THE FIELD.
4. THE CONTRACTOR SHALL DETERMINE THE EXACT LOCATION OF ALL EXISTING UTILITIES BEFORE COMMENCING WORK, AND AGREES TO ASSUME ALL LIABILITY FOR ANY AND ALL DAMAGES WHICH MAY OCCUR DUE TO THE CONTRACTOR'S FAILURE TO PHYSICALLY LOCATE AND PRESERVE ANY AND ALL UNDERGROUND UTILITIES.
5. ALL WORK SHALL BE PER OSHA AND APPLICABLE FEDERAL, STATE AND LOCAL CODE REQUIREMENTS.
6. THE CONTRACTOR SHALL SECURE ALL REQUIRED ENCROACHMENT AND/OR OTHER PERMITS FROM ALL GOVERNING AGENCIES BEFORE THE COMMENCEMENT OF WORK.
7. CONTRACTOR AGREES THAT HE/SHE SHALL ASSUME SOLE AND COMPLETE RESPONSIBILITY FOR JOB SITE CONDITIONS DURING THE COURSE OF CONSTRUCTION OF THIS PROJECT, INCLUDING SAFETY OF ALL PERSONS AND PROPERTY, THAT THIS REQUIREMENT SHALL APPLY CONTINUOUSLY AND NOT BE LIMITED TO NORMAL WORKING HOURS; AND THAT THE CONTRACTOR SHALL DEFEND, INDEMNIFY AND HOLD HARMLESS THE OWNER, ARCHITECT, CITY, AND ENGINEER FROM ANY AND ALL LIABILITY, REAL OR ALLEGED, IN CONNECTION WITH THE PERFORMANCE OF WORK ON THIS PROJECT, EXCEPT FOR LIABILITY ARISING FROM THE SOLE NEGLIGENCE OF THE OWNER, ARCHITECT, OR ENGINEER. THE ENGINEER ASSUMES NO RESPONSIBILITY EXCEPT FOR THE ADEQUACY OF HIS DESIGN CONTAINED HEREIN.
8. EXISTING A.C. PAVING AND/OR CONCRETE SHALL BE CUT TO A NEAT, STRAIGHT LINE (WHEN APPLICABLE). INITIAL CUT SHALL BE EQUAL TO THE WIDTH OF TRENCH; FINAL CUT SHALL BE 6" WIDER ON EACH SIDE PER CITY OF ATWATER STANDARD PLAN T-1. ALL EXPOSED VERTICAL SURFACES SHALL BE JACK COATED BELOW FINISH GRADE LINE WITH ASPHALT EMULSION PRIOR TO PAVING.
9. ALL SURVEY MONUMENTS WITHIN THE AREA OF CONSTRUCTION SHALL BE PRESERVED OR, IF DAMAGED, RESET BY A LICENSED LAND SURVEYOR AT THE EXPENSE OF THE CONTRACTOR.
10. ALL GRADING SHALL CONFORM TO CITY GRADING ORDINANCE AND SHALL BE IN ACCORDANCE WITH 2013 CBC APPENDIX J AND ANY APPLICABLE CALTRANS SPECIFICATIONS.
11. NO GRADING SHALL BE ONTO ADJACENT PROPERTY WITHOUT WRITTEN PERMISSION OF PROPERTY OWNER.
12. THE CONTRACTOR SHALL OBTAIN A GRADING PERMIT AND ABIDE BY ALL CONDITIONS THEREOF AND PAY PERMIT FEES.
13. CONTRACTOR IS RESPONSIBLE FOR RESETTING EXISTING MONITORING WELLS, MANHOLES, CLEAN-OUTS, VALVE BOXES, UTILITY VAULTS, OR ANY OTHER STRUCTURES TO REMAIN, TO FINISH GRADE AS NECESSARY AND THESE SHALL BE INCLUDED IN THE CONTRACTOR'S RESPONSE TO THE REQUEST FOR BID.
14. UNLESS OTHERWISE NOTED, ALL CURBS SHALL HAVE A 6" CURB FACE. DRILL AND EPOXY REBAR WHEN ABUTTING EXISTING CURBS.
15. ASPHALTIC CONCRETE PAVEMENT SHALL BE PLACED IN TWO OR MORE LIFTS PER CITY STANDARD SPECIFICATIONS.
16. THE CONTRACTOR SHALL REMOVE ALL ROOTS WITHIN 24" OF PROPOSED CONCRETE CURB, GUTTER, SIDEWALK AND DRIVEWAYS.
17. CONCRETE CONFORM FOR PRIVATE SIDEWALKS AND DRIVEWAYS SHALL NOT EXCEED A MAXIMUM SLOPE OF 12%. CONTRACTOR MAY HAVE TO REMOVE ADDITIONAL CONCRETE TO ACCOMPLISH THE MAXIMUM 12% CONFORM.
18. INSTALL ROOT BARRIERS PER DETAIL J SHEET 15 AT ALL LOCATIONS WHERE SIDEWALK AND/OR CURB AND GUTTER WILL BE CONSTRUCTED ADJACENT TO EXISTING TREES.



No.	MM/YY	Description	By	App'd.

Client/Project: CITY OF ATWATER DOWNTOWN PEDESTRIAN IMPROVEMENT PROJECT - PHASE II  
 BID CALL NUMBER: 731-25  
 CITY PROJECT NUMBER: 20-8  
 FEDERAL PROJECT NUMBERS: CML-5254 (031) & CRP-5254 (031)  
 ATWATER, CALIFORNIA

Title: CONSTRUCTION PLAN

Engineer's Seal: REGISTERED PROFESSIONAL ENGINEER IN CALIFORNIA, CIVIL, ROBERT FRANCIS CHRISTENSEN, No. 43087, Exp. 06-30-26. Signature: Robert Francis Christensen

Signature Date: 01.15.2025

**811**

Know what's below. Call before you dig.

Project Engineer: ROB CHRISTENSEN  
 Project Number: 1093-1200  
 File Name: 11\_CONST  
 AR RC AR 01.16.25  
 Dwn Chkd. Dgmn. MM.DD.YY  
 Sheet No.









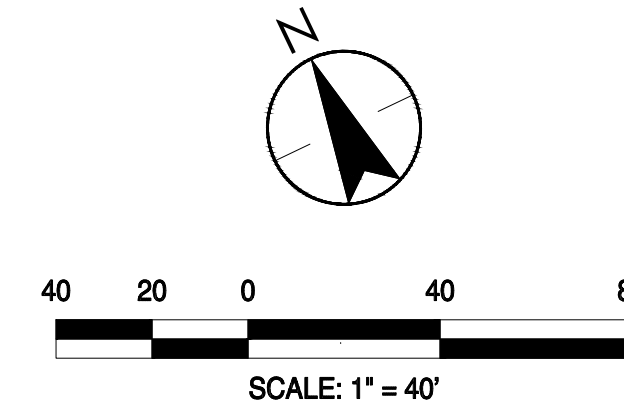
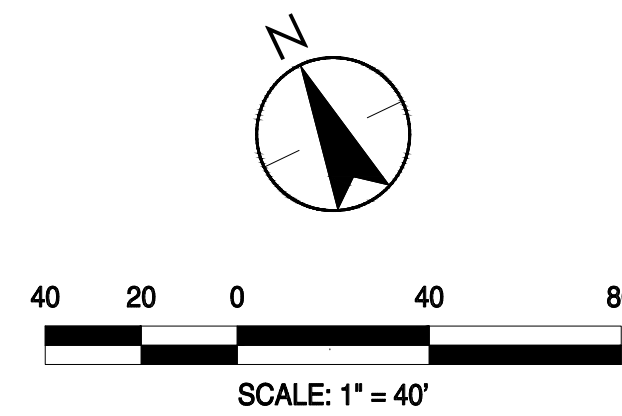
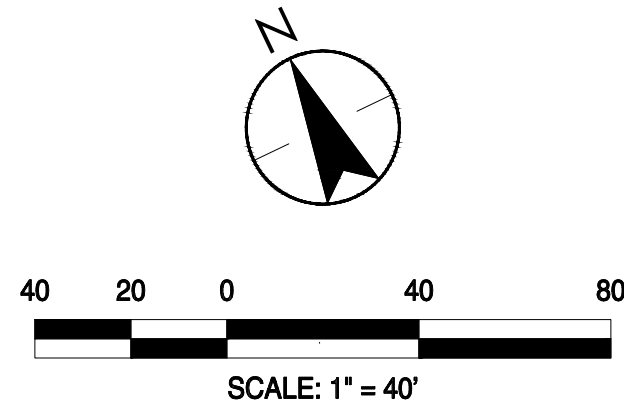
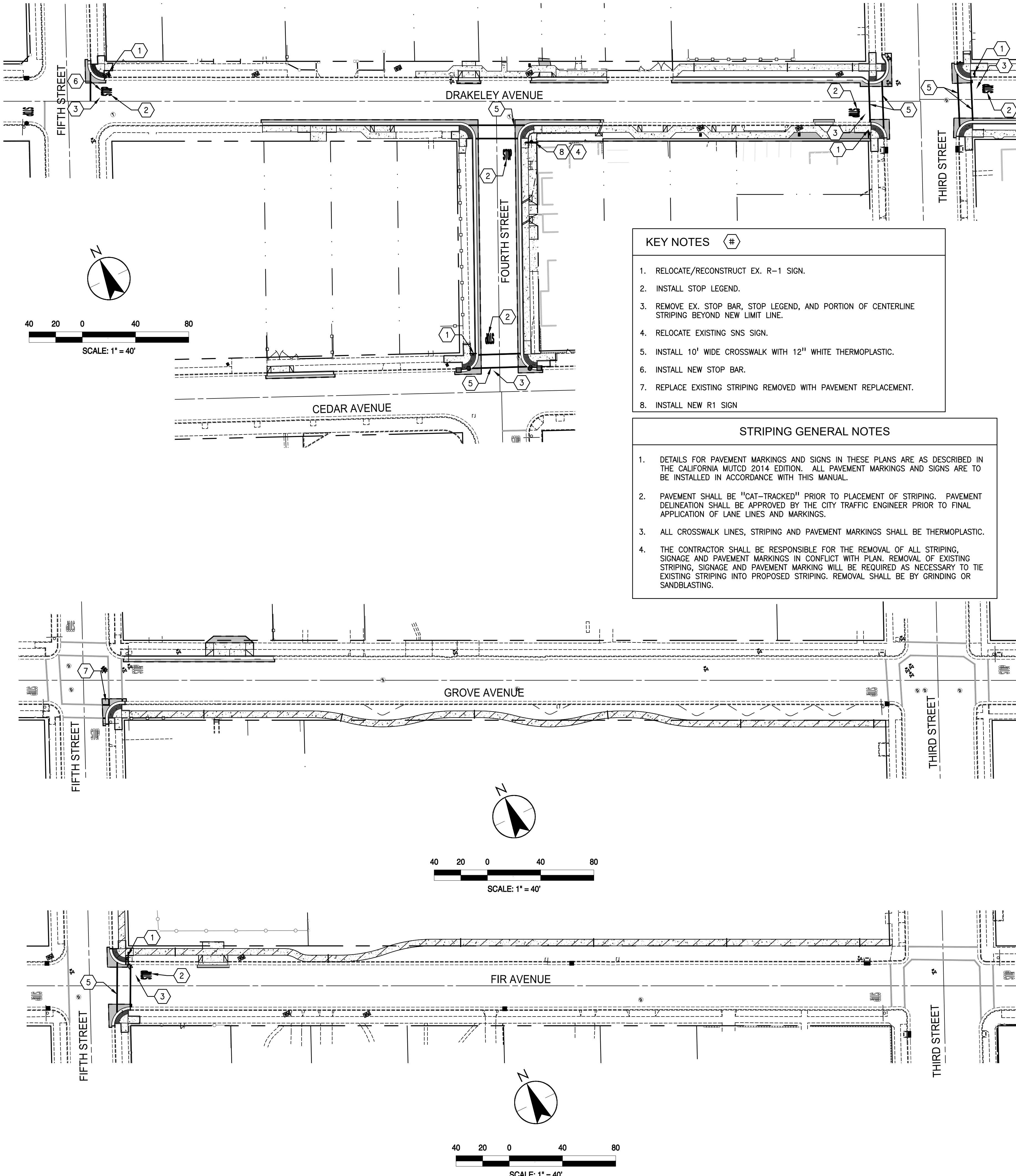

- KEY NOTES** (#)
1. RELOCATE/RECONSTRUCT EX. R-1 SIGN.
  2. INSTALL STOP LEGEND.
  3. REMOVE EX. STOP BAR, STOP LEGEND, AND PORTION OF CENTERLINE STRIPING BEYOND NEW LIMIT LINE.
  4. RELOCATE EXISTING SNS SIGN.
  5. INSTALL 10' WIDE CROSSWALK WITH 12" WHITE THERMOPLASTIC.
  6. INSTALL NEW STOP BAR.
  7. REPLACE EXISTING STRIPING REMOVED WITH PAVEMENT REPLACEMENT.
  8. INSTALL NEW R1 SIGN

- STRIPING GENERAL NOTES**
1. DETAILS FOR PAVEMENT MARKINGS AND SIGNS IN THESE PLANS ARE AS DESCRIBED IN THE CALIFORNIA MUTCD 2014 EDITION. ALL PAVEMENT MARKINGS AND SIGNS ARE TO BE INSTALLED IN ACCORDANCE WITH THIS MANUAL.
  2. PAVEMENT SHALL BE "CAT-TRACKED" PRIOR TO PLACEMENT OF STRIPING. PAVEMENT DELINEATION SHALL BE APPROVED BY THE CITY TRAFFIC ENGINEER PRIOR TO FINAL APPLICATION OF LANE LINES AND MARKINGS.
  3. ALL CROSSWALK LINES, STRIPING AND PAVEMENT MARKINGS SHALL BE THERMOPLASTIC.
  4. THE CONTRACTOR SHALL BE RESPONSIBLE FOR THE REMOVAL OF ALL STRIPING, SIGNAGE AND PAVEMENT MARKINGS IN CONFLICT WITH PLAN. REMOVAL OF EXISTING STRIPING, SIGNAGE AND PAVEMENT MARKING WILL BE REQUIRED AS NECESSARY TO TIE EXISTING STRIPING INTO PROPOSED STRIPING. REMOVAL SHALL BE BY GRINDING OR SANDBLASTING.

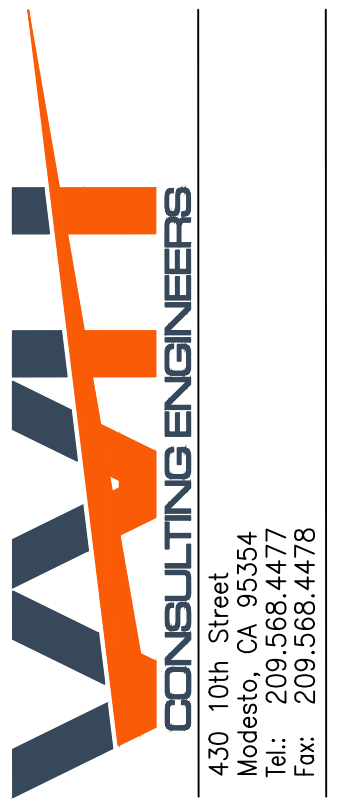
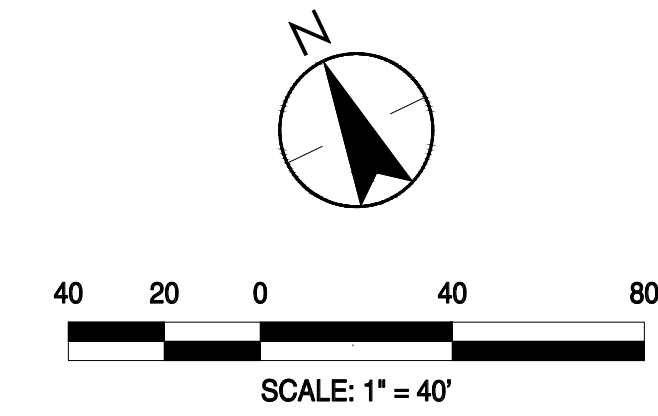
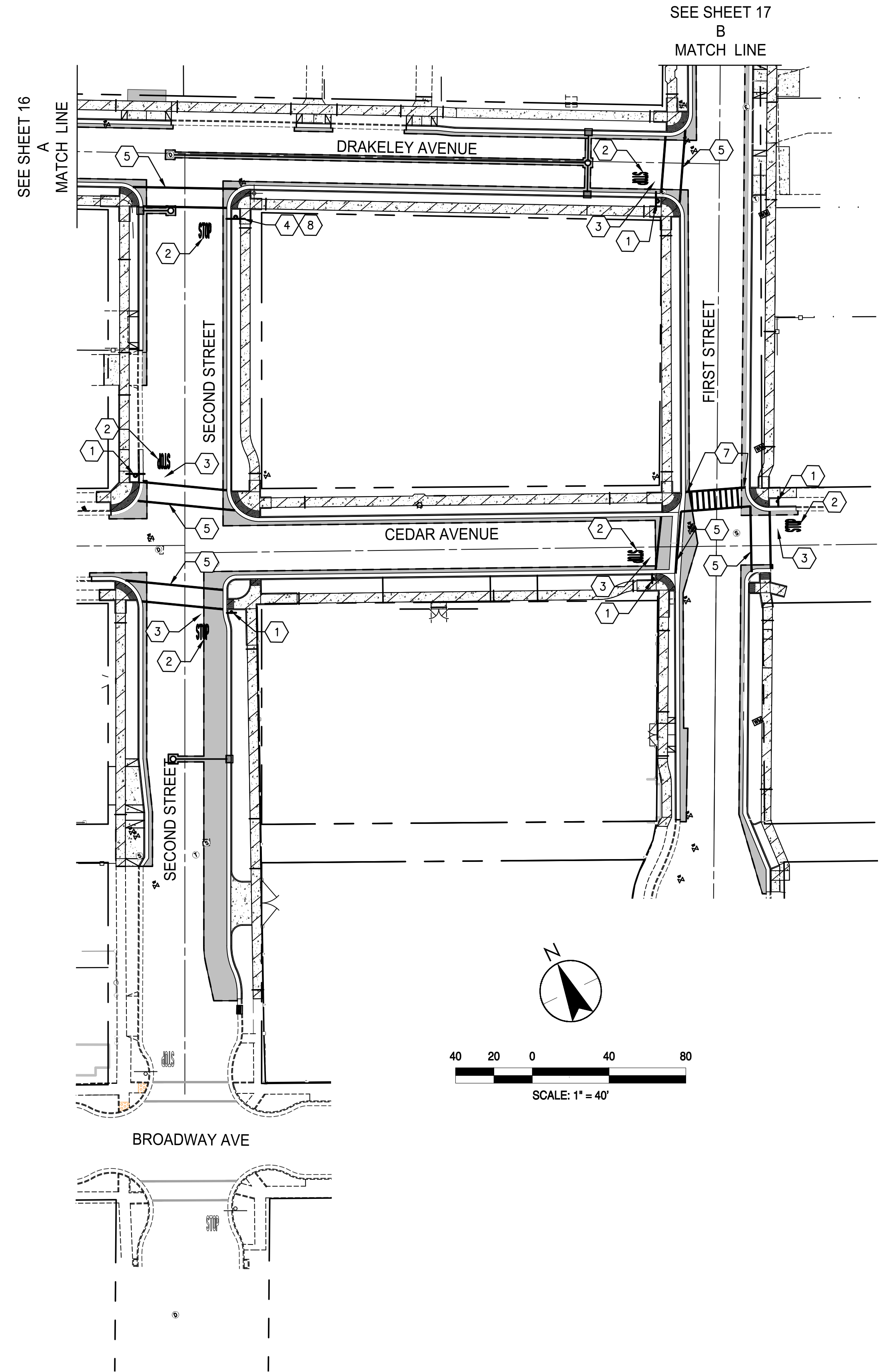
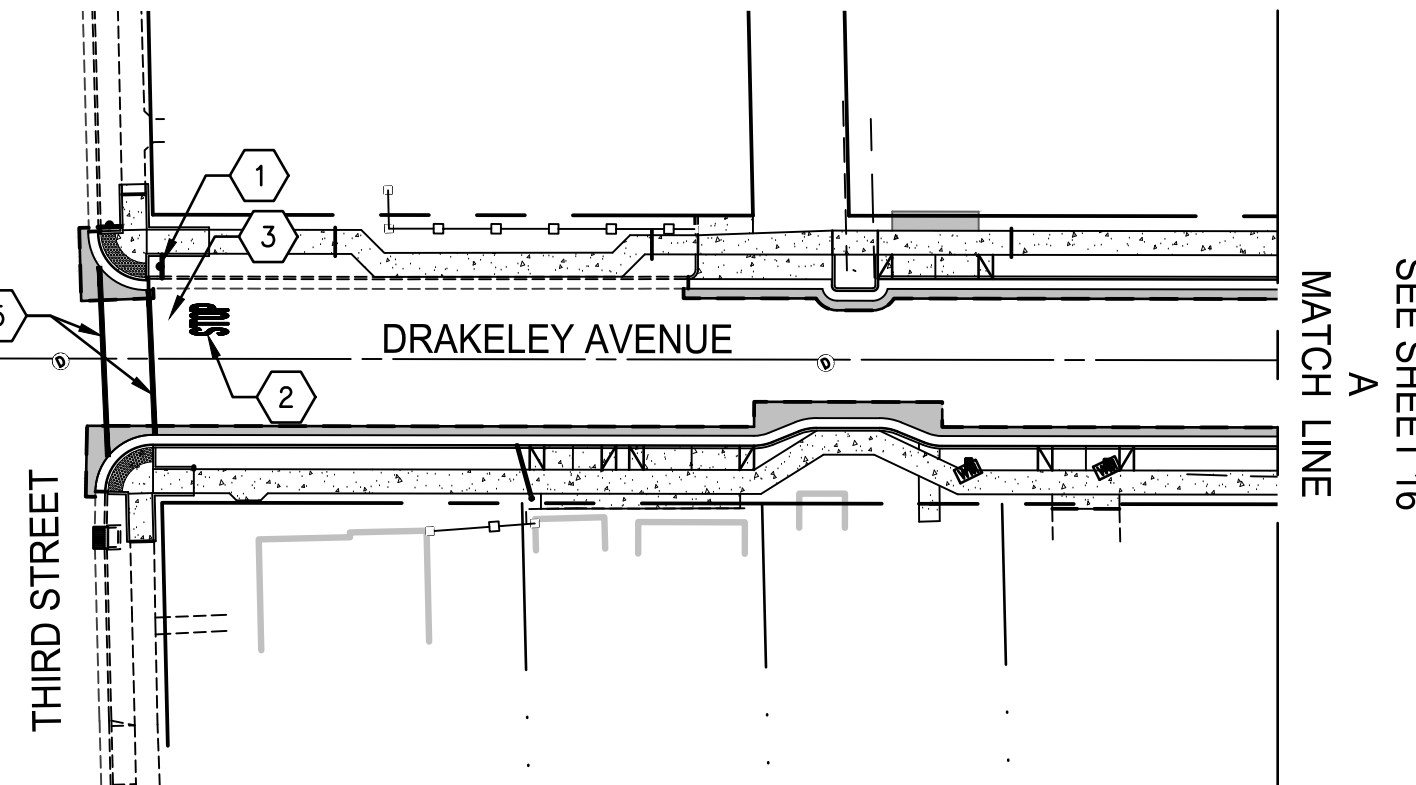

No.	MM.YY	Description	By	Appd.

Client/Project  
 CITY OF ATWATER  
 DOWNTOWN PEDESTRIAN IMPROVEMENT PROJECT - PHASE II  
 BID CALL NUMBER: 731-25  
 CITY PROJECT NUMBER - 20-8  
 FEDERAL PROJECT NUMBERS - CML-5254 (031) & CRP-5254 (031)  
 ATWATER, CALIFORNIA

Engineer's Seal  
  
 Engineer's Signature: *Rob Christensen*  
 Signature Date: 01.15.2025

**811**  
 Know what's below.  
 Call before you dig.

Project Engineer: ROB CHRISTENSEN  
 Project Number: 1093-1200  
 File Name: 16\_STRP  
 AR RC AR 01.16.25  
 Dwn Chkd. Dsgn. MM-DD-YY  
 Sheet No.

\\1\1051\251\c\1\2\16\16\_STRP.dwg  
 2025-01-15 07:25:59  
 ORIGINAL SHEET - ARCH D

