

# FRAMING AND FOOTING DETAILS

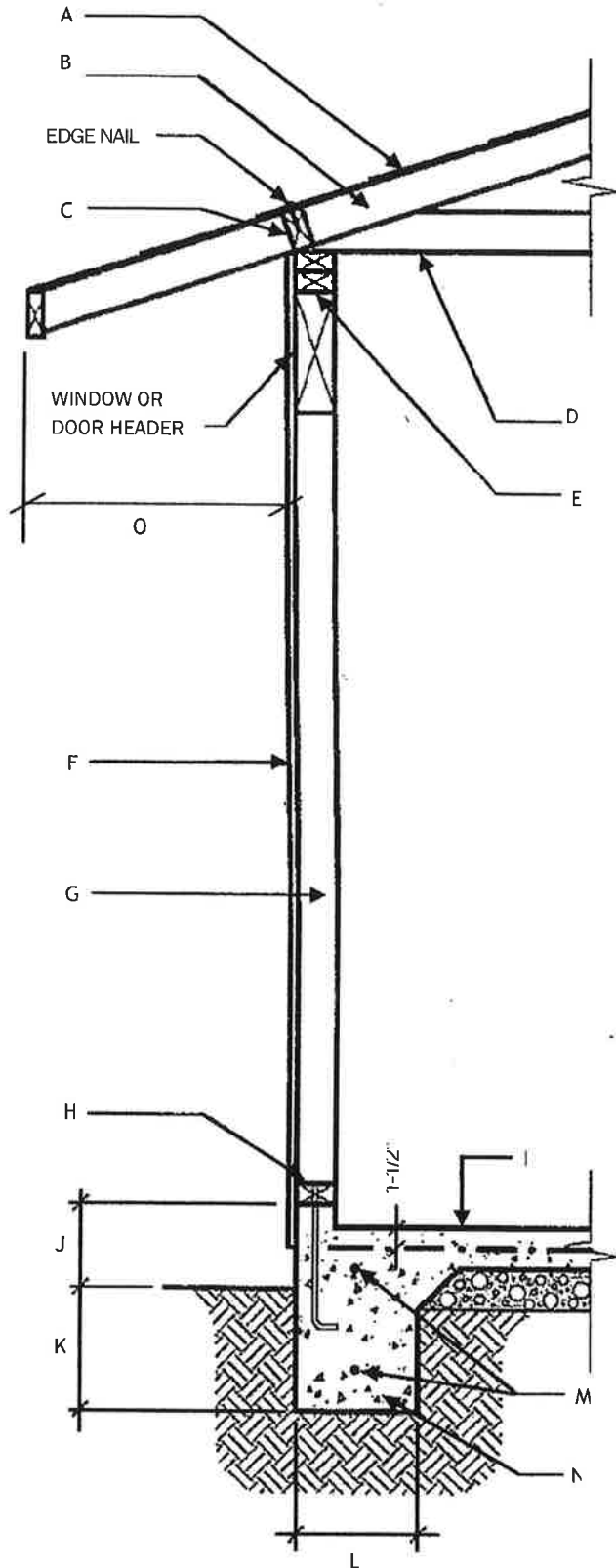

A. ROOF COVERING ON 15# FELT PAPER ON PLYWOOD OR 1" x 4" SKIP SHEATHING (WOOD SHAKE OR WOOD SHINGLE ONLY). PLYWOOD EDGE NAIL 8d @ 6" O.C. \_\_\_\_\_" THICK, \_\_\_\_\_ SHEATHING

B. MANUFACTURED TRUSSES OR RAFTERS. IF TRUSSES ARE USED, PROVIDE TRUSS CALCULATIONS. RAFTERS: 2" x \_\_\_\_\_" @ \_\_\_\_\_ O.C. (REFER TO ALLOWABLE SPAN FOR RAFTERS)

C. BLOCKING OR EAVE VENTS WITH 16d NAILS @ 8" O.C. TO DBL TOP PLATE. REFER TO FASTENING SCHEDULE.

D. CEILING JOIST: 2" x \_\_\_\_\_" @ \_\_\_\_\_ O.C. (REFER TO ALLOWABLE SPAN FOR CEILING JOIST)

E. DOUBLE TOP PLATE (MIN. 48" SPLICE) WITH 12 (16d) NAILS @ EACH SIDE OF SPLICE

F. SIDING MATERIAL: \_\_\_\_\_

G. STUD WALL WITH 2" x \_\_\_\_\_" STUDS @ 16" O.C.

H. BOTTOM PLATE (PRESSURE-TREATED WHEN IN CONTACT WITH CONCRETE) WITH 1/2" x 10" ANCHOR BOLT @ 6' O.C. MAX (MIN. TWO BOLTS PER SILL SECTION). MINIMUM 3" x 3" WASHERS.

I. 3-1/2" CONCRETE SLAB

J. 6" MINIMUM CLEARANCE TO GRADE

K. 12" DEEP BELOW UNDISTURBED SOIL

L. 12" WIDE

M. (2) #4 REINFORCING BARS (CONTINUOUS)

N. CONCRETE FOUNDATION

O. EAVE DIMENSION: